

Quick User Guide

LIBERTY™ 400

Maytronics Dolphin Cordless Robotic Pool Cleaner

What's in the Box

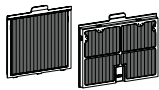

Extra filter panels

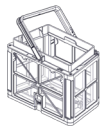

Filter basket



Grab hook



Clicker

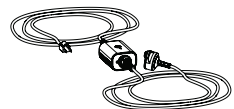

Charger

First Time Use

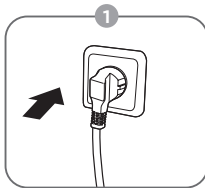

Plug the charger into the wall outlet

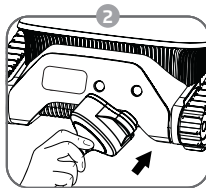

Connect the inductive charger to the robot



Peel-off the sticker

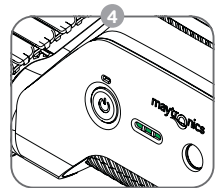

Charge the battery to 100% - 3 green bars

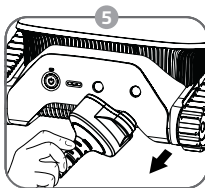

Unplug the inductive charger

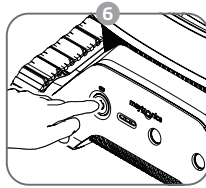

Press the power button

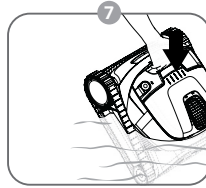

Put the robot in the pool. It will start cleaning within 30 seconds

Quick User Guide

Features and Indications



Cycle Selector

Use Cycle Selector to customize cleaning mode to "Floor only":

1. Press ON to activate until the LED lights up.
2. Press ON again for 3-6 seconds until the purple LED blinks 3 times. Place the robot in the pool, and within 30 sec, it will start working. After each cleaning cycle, the robot will return to default mode.



Step 1



Step 2



ClickUp™

Easily take the robot out of the pool by shaking the Clicker in the water for 3 seconds. The robot will climb up its nearest wall and wait a few seconds to be picked up.



Eco Mode

Use Eco Mode to keep your pool floor clean for a week on one charge. The robot will automatically clean the pool floor for up to 30 min, three times a week, with 48 hours between cleaning cycles.

1. Press ON to activate until LED lights up.
2. Press ON again for 6 seconds until green LED blinks. Place the robot in the pool, and within 30 sec, it will start working.



Step 1



Step 2



Temperature Warning

In case of temperature warning notification, place and charge the pool cleaner in a protected and shaded area, at a temperature range of 6°C - 35°C / 43°F - 95°F.



Waterline Scrubbing

Scrubs then removes grime and oils that accumulate on the waterline.



MyDolphin™ Plus Mobile App

Download the app, sign-up and follow the app instructions to pair with your robot. You can configure it with the MyDolphin™ Plus App while the robot is out of the water. When paired, the LED above the robot's power button will start flashing. Now you can schedule cleanups, set cleaning cycle type, and receive notifications when it is ready to be taken out of the pool.



Error

In case of error notification, please refer to User Manual.



Quick User Guide

Removing the robot from the pool

Grab hook - Pull robot to waterline, then grab it.



* Standard pole, not included

ClickUp™

After the cleaning cycle, shake the Clicker inside the water for over 3 seconds and the robot will climb its nearest wall. The robot needs to finish its cycle before it can be called up with the Clicker.

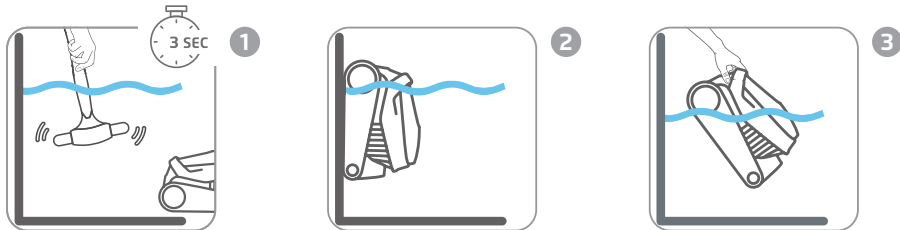

End of Cycle Pickup

In the last few minutes of its cleaning cycle, it will climb each wall and wait 20 seconds to be taken out. If you started the cycle with the app, you will get a push notification on your phone to let you know the robot is waiting. If it isn't picked up, it will wait on the floor near a wall. You can then use the Clicker or hook to take it out.

Cleaning the Filter Basket

To prevent debris from hardening on the filter, we highly recommend quick-rinsing the filter immediately after removing the robot from the pool.

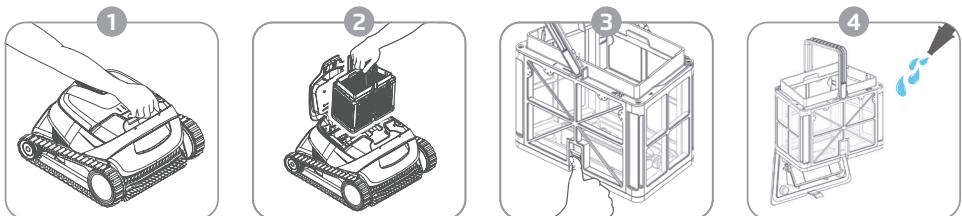

Quick User Guide

Charging Recommendations

- When the battery is low and all indicators are off - the cleaner is on standby mode. Connect to the charger to wake it up.
- Always charge the pool cleaner in a protected and shaded area at a temperature range of 6°C - 35°C / 43°F - 95°F, until you see 3 green bars in the battery indicator panel (up to 6 hours).
- The charger is rainproof, the robot can be charged when wet. However, do not put the charger in the water. It is not designed to be underwater.

Off-Season Storage

Before off-season storage - Charge the battery to about 50% (2 green bars in the battery indicator panel).

Recommended storage temperature range: -10°C - 40°C / 14°F - 104°F.

Exceeding the maximum will likely damage the battery.

After off-season storage, charge the robot to its fullest.

Info and recommendations

Note

- Keep your fingers away from the impeller motor area to avoid injury.
- Any maintenance should be done only when the robot is off.
- Ensure that the electrical outlet is protected by a ground fault interrupter (GFI) or earth leakage interrupter.
- Do not put the charger in the pool.
- Do not enter the pool while the pool cleaner is working.
- In case of any physical damage to the pool cleaner or the charger, contact Customer Care for instructions.
- When removing the robot from the pool, set it on the edge to empty the water before lifting.
- Water temperature range: 6°C - 35°C / 43°F - 95°F
- Water depth range: 0.4m - 3m / 1.33ft - 9.8ft
- Motor protection: IP 68
- Charger protection: IP 54
- Chlorine - 4 ppm, Max.
- pH - 7.0-7.8
- NaCl - 5000 ppm, Max.
- Battery Lithium-ion | 5,000mAh



Scan for User Manual

For more information www.maytronics.com.au



EN CONNECTING THE ROBOT TO THE *MyDolphin™ Plus* APPLICATION

Compatibility:



Apple smart device (iOS)

Please ensure that you have an iOS 12.1 or later operating system.



Android smart device

Please ensure that you have an Android 5 or later operating system.

Before using the app, please review the set-up conditions:

Set-up conditions:

1. Ensure Bluetooth® is enabled in your smart device.
2. Android users - please make sure your GPS and Location Services are "ON".
For Android 12 and up - also enable "nearby devices" permission.
3. For iOS 13 or iOS 13 and above - please make sure to approve the *Bluetooth®* permissions.

Connecting the robotic cleaner to your smartphone:

4. Download the MyDolphin™ Plus app from the App Store or Google Play.
5. Make sure the robot is out of the pool during the pairing process.
Water interferes with the connection.
6. Turn on the robot's *Bluetooth®* by connecting it to the charger. You can also turn it on by pressing the power button twice - once to turn the LED on, and again to turn the LED off.
7. Activate the MyDolphin™ Plus app.
8. Sign up by creating an account or using your Gmail, Facebook, or Apple account.
9. Select the "Cordless" power source. The app will search for your robot.
10. When the app finds your robot, tap on the robot image to connect.
11. The app will start pairing with your robot. Please wait until the robot's LED blinks green and you receive a success message in the app.
12. Name your new Dolphin robotic cleaner.
13. Next time you open the app, you will be prompted to fill in the warranty.

Tip: If the app is stuck on the same screen for over 2 minutes, close the app and re-open it.



Download MyDolphin™ Plus App

Apple App Store



Google Play Store



MAYTRONICS is proud to offer you this commercial manufacturer warranty to ensure you derive additional enjoyment, confidence and pride from your Maytronics pool cleaner. **Please read this document carefully as it sets out the terms of your commercial warranty.**

We encourage you to register your warranty at registration.maytronics.com to benefit from special offers and advantages.

Important: Please note that due to the presence of a lithium battery within the pool cleaner there are specific requirements that apply to the safe storage, transportation and disposal of the pool cleaner. Please read the manual carefully. Maytronics and its authorized partners shall not be responsible for any malfunction, faults, damage or injury resulting from a failure to store, handle or dispose of the battery correctly in accordance with the instructions.

Who does this commercial warranty apply to?

This commercial warranty covers all Maytronics product models listed above that have been sold by an **Authorized Maytronics Reseller**. For a full list of authorized Maytronics resellers go to: www.maytronics.com

This commercial warranty only applies to the **first purchaser** so if you have bought a Maytronics pool cleaner second-hand, this warranty will **not** apply to you.

Who are we?

We are Maytronics International, a company incorporated in Israel with our registered office address at Kibbutz Yizre'el 1935000, Israel.

How long does this commercial warranty last?

Pool cleaner excluding the Battery: This commercial warranty lasts for a period of **36 months** from the date your pool cleaner was delivered to you or collected by you, as shown on your proof of purchase (the "**Commercial Warranty Period**").

Battery: This commercial warranty guarantees that the usable capacity of the battery in the pool cleaner will not fall below 70% within **36 months** from the date your pool cleaner was delivered to you or collected by you (as shown on your proof of purchase) or within **400 cleaning cycles**, whichever comes first, as long as the pool cleaner is used correctly.

What are your rights once the Commercial Warranty Period has ended?

After the Commercial Warranty Period has ended, you will no longer be entitled to a remedy for free under this commercial warranty. However, please note that in some countries you might still be entitled to statutory remedies for free from the seller who sold you the pool cleaner (please see the statutory rights linked below). If not, you can request a quotation for services from your Maytronics Reseller.

What does this commercial warranty cover?

This commercial warranty covers any defects in material or workmanship under normal use and service during the Commercial Warranty Period, subject to the exclusions set out below.

What does this commercial warranty entitle you to?

This commercial warranty entitles you to a free diagnosis and troubleshooting evaluation by an Authorized Maytronics Reseller or service station to ascertain what is wrong with your Maytronics pool cleaner (this may be conducted in person or telephonically).

If a manufacturing fault or defect is discovered during your free diagnosis and the pool cleaner is still covered under this commercial warranty, your Authorized Maytronics Reseller will attempt to remedy the problem within [48] hours.

In some instances, it may be necessary to send the pool cleaner to an authorized Maytronics service station for further analysis. If a manufacturing defect is discovered, your pool cleaner will be repaired for free as quickly as possible (where a repair is possible). If a repair is not possible, your pool cleaner will be replaced for no charge.

This can include replacement of any defective components with refurbished components and/or units.



Manufactured by **Maytronics LTD**
Kibbutz Yizre'el, 1935000 ISRAEL

For online product
warranty registration:
registration.maytronics.com



Battery: If the battery maximum capacity declines below 70% of the original declared capacity within the first **36 months and you have not operated the unit more than 400 cleaning cycles**, the battery unit is eligible for replacement. Please note that if stored for a long period of time the battery charge level may be impacted. Please refer to the user manual for adequate storing instructions.

What happens if a warranty exclusion applies?

If no manufacturing defect is discovered or one of the warranty exclusions applies (see below for more information), this commercial warranty will not apply. In these circumstances, the following will occur:

1. You may request a quotation for the repair cost; and
2. If accepted, your unit will be repaired and returned to you at your cost or made available for your collection; or If not accepted, your unit will be returned to you at your cost or made available for your collection.

Warranty exclusions - what this warranty does not cover

This commercial warranty does **not** cover your pool cleaner if any of the following apply:

- You have used it outside of the pool cleaner's normal, recommended and reasonable use or have stored the pool cleaner inadequately when not in use. Please note there are specific instructions in the manual for storage and use due to the battery contained in the pool cleaner.
- You have not complied with the official Maytronics operating manual, including user instructions as to necessary maintenance.
- The defects, damage, malfunctions or failures have not occurred as a result of a manufacturing defect.
- You have used components other than genuine components manufactured by Maytronics.
- You have had the pool cleaner repaired or serviced by any reseller, service station or person other than an Authorized Maytronics Reseller or authorized Maytronics service station.
- If you or an unauthorised service station have broken the battery seal, this will invalidate the commercial warranty for the battery.
- You have overcharged the battery by using a non-specified input power.
- The battery is equipped with a smart card that records usage and charging. Through the smart card, Maytronics can track battery performance as well as any misuse or incorrect maintenance.
- You have used the pool cleaner in pools with more than 5000 PPM of salt particles (Maytronics pool cleaners are designed to work in water with salt particles up to 5000 PPM).
- Maytronics hereby disclaims any and all claims for damage caused by your pool cleaner due to the incorrect storage, use and/or operation of your Maytronics pool cleaner, including damage to property, pool plaster or vinyl liner. Incorrect storage, use and/or operation means any storage, use and/or operation not in compliance with the operation manual or instructions.

How do I make a claim under this commercial warranty?

1. Contact [your Authorized Maytronics Reseller from whom you bought your pool cleaner].
2. Provide a copy of your receipt or other proof of purchase. Note that if you registered your warranty at <https://registration.maytronics.com/>, you will not need to show your proof of purchase.
3. Make available for collection, post or drop off your pool cleaner to your Authorized Maytronics Reseller or the service station address indicated by them. If you arrange for postage or delivery yourself, please retain a copy of the postage / delivery receipt and costs, since these will be reimbursed if a manufacturing defect covered by this commercial warranty is discovered.

Your Authorized Maytronics Reseller will keep you updated on the timings of any further repairs or services deemed necessary so that you can get back to enjoying the benefits of your Maytronics pool cleaner as soon as possible.

Severance

If any court or relevant authority decides that any of the limitations or exclusions in this commercial warranty are unenforceable, this warranty will be deemed modified to the minimum extent necessary to make it enforceable. If such modification is not possible, the relevant provision should be deemed deleted. Any modification or deletion will not affect the validity of the rest of this commercial warranty.

Exclusive remedies against Maytronics

The remedies as set out in this commercial warranty are the exclusive remedies available to you from Maytronics. However, you may have additional legal rights directly from the seller under law and this commercial warranty does not remove or limit any such rights.

If you have questions about your statutory warranty rights under national consumer laws, please go to <https://global.maytronics.com/terms-of-service>

maytronics™



8081050

Maytronics Dolphin Robotic Pool Cleaner

LIBERTY™

EN Safety Instructions

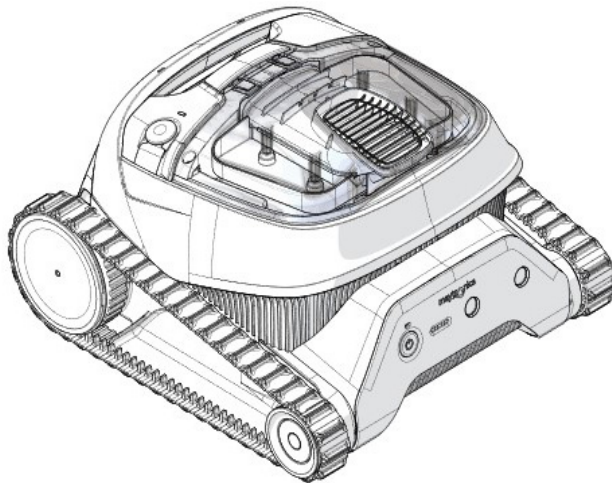



IMPORTANT SAFETY INSTRUCTIONS

READ AND FOLLOW ALL INSTRUCTIONS

Please adhere strictly to the following **WARNINGS**:



Remove the robotic pool cleaner from the pool before allowing people to enter the pool.



When examining the robotic pool cleaner, make sure the robotic pool cleaner is switched OFF.



Charge the battery only in the temperature range between 6°C to 35°C / 43°F to 95°F.



Keep the robotic pool cleaner out of the reach of children or persons with reduced physical, sensory, or mental capabilities, or lack of experience and knowledge, unless they have been given supervision or instruction.
Cleaning and maintenance shall not be done by children.



Use only the original battery charger.



- The battery charger must be supplied through a residual current device (RCD) having a rated residual operating current not exceeding 30mA.
For USA/Canada installations:
- The battery charger must be connected only to a supply circuit that is protected by a ground fault circuit interrupter (GFCI). This GFCI should be tested on a routine basis.
- To test the GFCI, push the test button. The GFCI should interrupt power. Push the reset button. Power should be restored. If the GFCI fails to operate in this manner, the GFCI is defective.
- If the GFCI interrupts power to the battery charger without the test button being pushed, a ground current may be flowing, indicating the possibility of an electric shock. Do not use the battery charger. Disconnect the battery charger and contact the manufacturer for assistance.



The power cord is not user-replaceable. If the power cord is damaged, stop using the battery charger and contact the service center for repair. Do not use extension cord to connect the battery charger to electric supply; provide a properly located outlet.



DO NOT USE the robotic pool cleaner and/or its battery / power pack in case of mechanical damage to the robotic pool cleaner and/or its battery.



To avoid the risk of fire and burns, DO NOT open, crush, heat, or burn the battery case.

IMPORTANT SAFETY INSTRUCTIONS



Please ensure that the following **PRECAUTIONS** are implemented:



For continuous protection against possible electric shock, place the battery charger at least 11 cm / 4 in above ground.



Position the battery charger at least 3.5 m / 12 ft from pool edge during operation.



Keep hands and fingers away from impeller motor area and driving belt mechanism to avoid injury.



When lifting the robotic pool cleaner, take care to prevent back injury.



Do not use the robotic pool cleaner if you have added liquid flocculant or any other clarifier to the pool water.
These substances obstruct and damage the robot filters.



The Lithium-Ion battery in this product is non-replaceable. It should be recycled at certified battery electronics recyclers that accept batteries. Batteries should NOT be discarded in the trash or put in municipal recycling bins. Do not disassemble the battery.

Specifications

Robot

- Motor and Power Pack protection: IP68
 - Minimum depth: 0.4 m / 1.33 ft
 - Maximum depth: 3 m / 9.8 ft
 - Radio communication: Bluetooth®
- 5.0 - 2402-2480 MHz - Maximum power 2.1mW

Battery Charger

- Protection: IP54 (Raintight)
- Output: <30 VDC

Water Conditions

Use the robotic pool cleaner only in the following water conditions:

- Chlorine: 4 ppm max.
 - pH: 7.0 – 7.8
 - Temperature: 6°C – 35°C / 43°F – 95°F
- Note:** below 15°C / 59°F, climbing performance may be affected.
- NaCl: 5000 ppm max.

SAVE THESE INSTRUCTIONS

This product complies with European Regulation and Directive 2014/5/1EU.

For full information, please contact us at

www.maytronics.com/contact-us-en and ask for the EU Declaration of Conformity.

